

TOHNICHI

Digital Torque Wrench

Model : CEM3 series

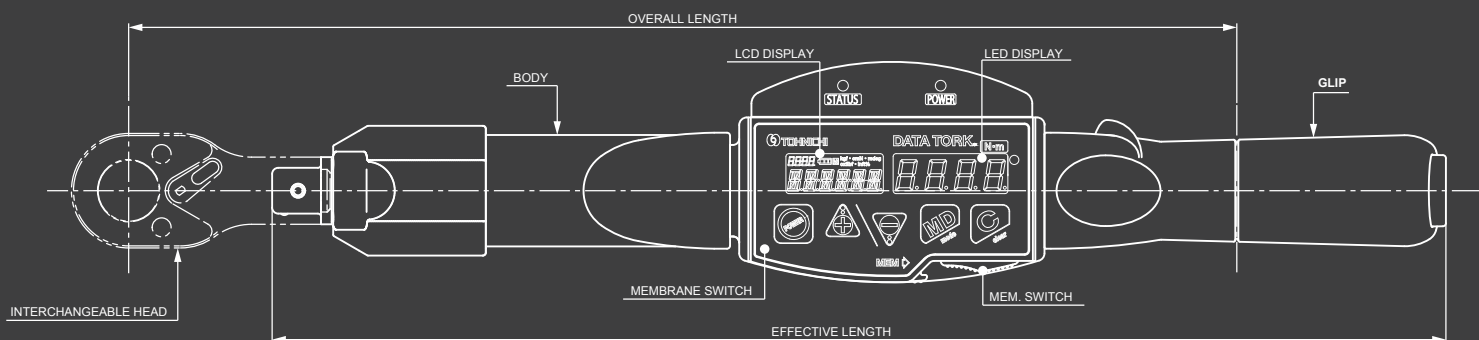

Tightening torque

Loosening torque

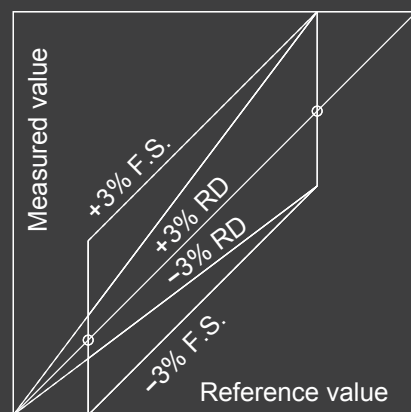
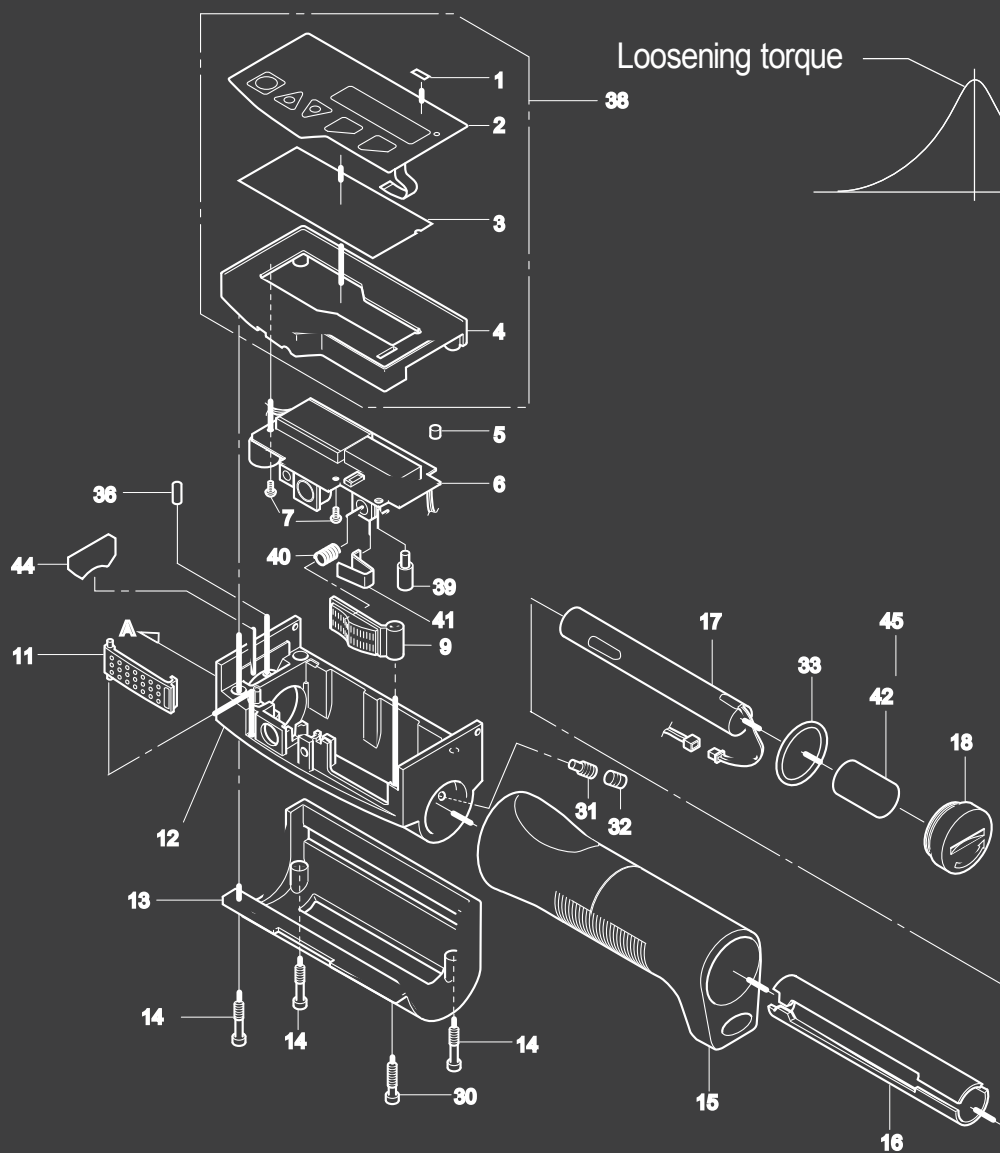
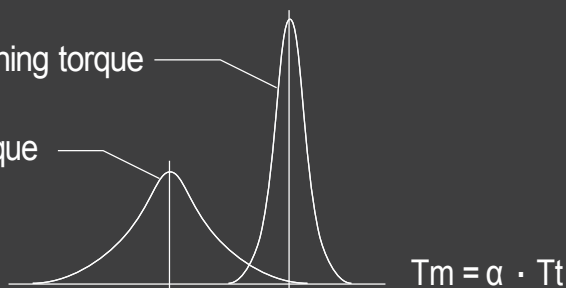

DIGITAL TORQUE WRENCH

Standard Digital Torque Wrench

CEM3-G

RoHS CE

*Standard model digital torque wrench
For tightening and inspection
Eye-friendly dual display LCD & LED*



Save up to 999 Data

Set up target torque by keys

- Saved data can be transferred to PC



Measured data can be output by ExRcv software which is offered at Tohnichi website

CEM3-P

RoHS CE

Quality inspection torque wrench with data management software that links work name with test results



100 works
3,000 Data

- Set target torque and work name on CEM3-P management software
- Saved data can be transferred to PC all at once

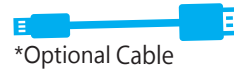

Max. 100 work name (work name, number of screws, tightening direction, upper/lower torque limit, measuring order)

Wireless LAN Data Transfer

CEM3-G-WF

RoHS FC

Wireless LAN communication

*Ideal for a wide working area **Approximately 50m***



Communication
Distance 50m

Save up to 999 Data

Wireless LAN
IEEE802.11

- Set target torque, upper limit and inspection sequence from software
- Transfer tightened data to PC/Server real time

Tohnichi special management software

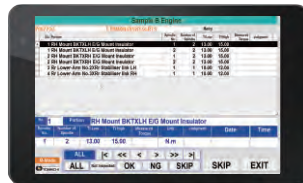

Individual IP address
International standard IEEE 802.11
2.4 GHz (Giga Hertz)
5 GHz dual band range



Interchangeable Head

CEM series has QH type interchangeable head as standard
Over 300 kinds of interchangeable head are available for a variety of work applications

CEM3 SERIES

Bluetooth Data Transfer

CEM3-G-BTS

Simplex communication, Suitable for inspection
Save and transfer data wirelessly in real time

RoHS CE FC



Communication Distance 10m

Save up to 999 Data



- Output data after each operation
- or
- Transfer a range of data at once from the memory

Management software TDMS
 or
 Order made software



*Optional

CEM3-G-BTD

Duplex communication, Ideal for mixed production lines
Easy to change target torque
Substitute for multiple pieces of standard torque wrench

RoHS CE FC



Communication Distance 10m

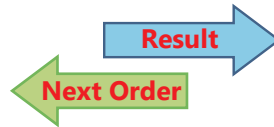

- Transfer torque record in real time to PC/tablet
- Receive next tightening torque value from a PC/tablet

Management software TDMS
 or
 Order made software



*Optional

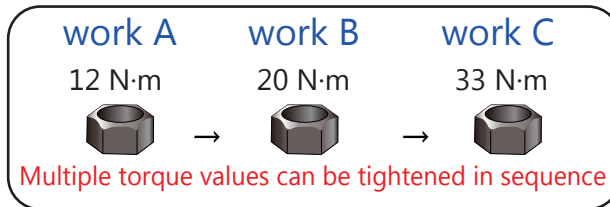

Save Data in Software

CEM3-G-BTA

Detect double tightening, measuring tightening angle
Judge OK/NG by both tightening torque and angle

RoHS CE FC



Communication Distance 10m

Save up to 999 Data



Angle monitoring at the peak tightening torque
 LED light and buzzer alert when reach **Target Torque**

- Set from software or by keys
- Transfer tightening data to PC/tablet



Judgment Result Display

Counter Judgment Judgment LED

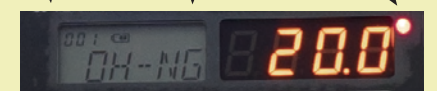

Torque/Angle Measured Torque Value

Judgment Symbol

- L :Less than the lower limit (Low-NG)
- O :OK
- H :Beyond the upper limit (High-NG)
- D :Double tightening (NG tightening)



Other Digital Products

CTA2-G
RoHS CE

Digital torque wrench for angle tightening
Suitable for production use
Judge OK/NG by Angle



Save up to 999 data

Upon reaching snug torque, the values on the display switch to angle values
LED light and buzzer alert when it reaches **Target Angle**

- Set Snug Torque & Target Angle from software or by keys
- Transfer saved data to PC all at once

Includes software for data management



Able to check Angle and Torque while tightening



CTB2-G
RoHS CE

Digital torque wrench for re-tightening inspection
Technical skill is not necessary to detect the applied torque

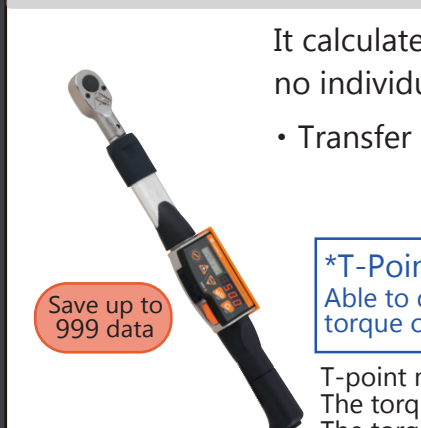

Save up to 999 data

It calculates applied torque automatically on re-tightening inspection with no individual difference, Technical skill is not necessary

- Transfer saved data to PC all at once

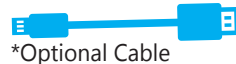

***T-Point Method**
Able to detect torque value closest to tightened torque compare to other measurement method

T-point method figures TT as retightening torque value.
The torque which overcome the static friction of the bolt (A point)
The torque at which the bolt starts on turn continuously (B point)
The maximum torque at this inspection (C point)

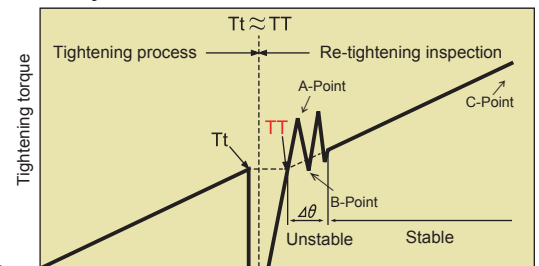

TDMS

Tightening data management system



Indicate application name, Number of spindle, High/Low torque value, application order
Show tightened data and judgment in real time
Show next portion after one tightening is complete
Statistic processing [N], [X-bar], [σ], [cp], and [cpk] for analysis of quality trends

Available Blue tooth Product
CEM3-G-BTS CEM3-G-BTD
CTB2-G-BT STC2-G-BT

Model	Description	Language
TDMS		Japanese
TDMS-E	Software only	English
TDMS-C		Chinese



Promotional videos are available on YouTube. Visit Tohnichi TV!
<https://www.youtube.com/c/TohnichiTV>



The TUD symbol indicates that our products are ergonomically designed and adapted for Color Vision Deficiencies.

TOHNICHI MFG CO., LTD.
URL <http://www.global-tohnichi.com>
E-mail overseas@tohnichi.co.jp
N.V. TOHNICHI EUROPE S.A.
E-mail europa@tohnichi.com
TOHNICHI AMERICA CORP.
URL <http://www.tohnichi.com>
E-mail inquiry@tohnichi.com
TOHNICHI SHANGHAI MFG. CO., LTD.
URL <http://www.tohnichi-sh.com>
E-mail sales@tohnichi-sh.com
TATSO
Tohnichi Asia Technical Support Office
Sriracha, Thailand
Tel. +66 33 002307 Fax +66 33 002337



- Contact Tohnichi for status of wireless certification acquisition for each country.
- The appearance and specifications are subject to change for improvement without prior notice.
- ©TOHNICHI Mfg. CO., LTD. All Rights Reserved.